

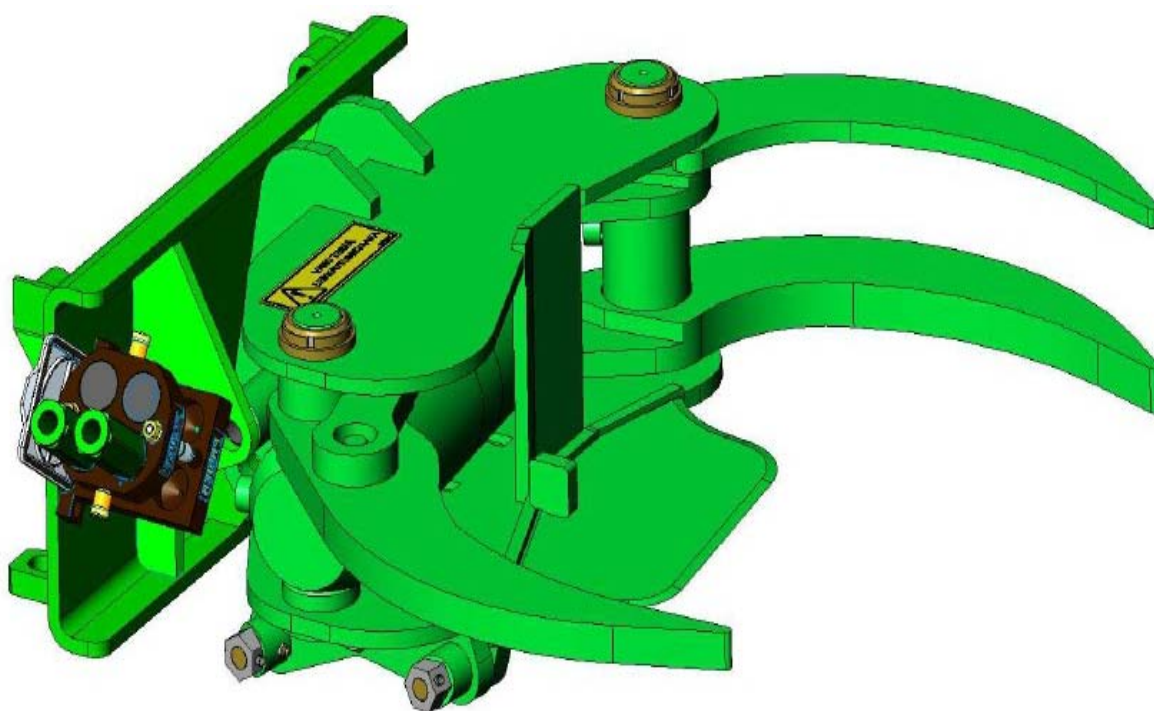

# **KESLA**

**19G** AVANT

**ENERGIAPUUKOURA**



**VARAOSAT**

29012924

KOURA

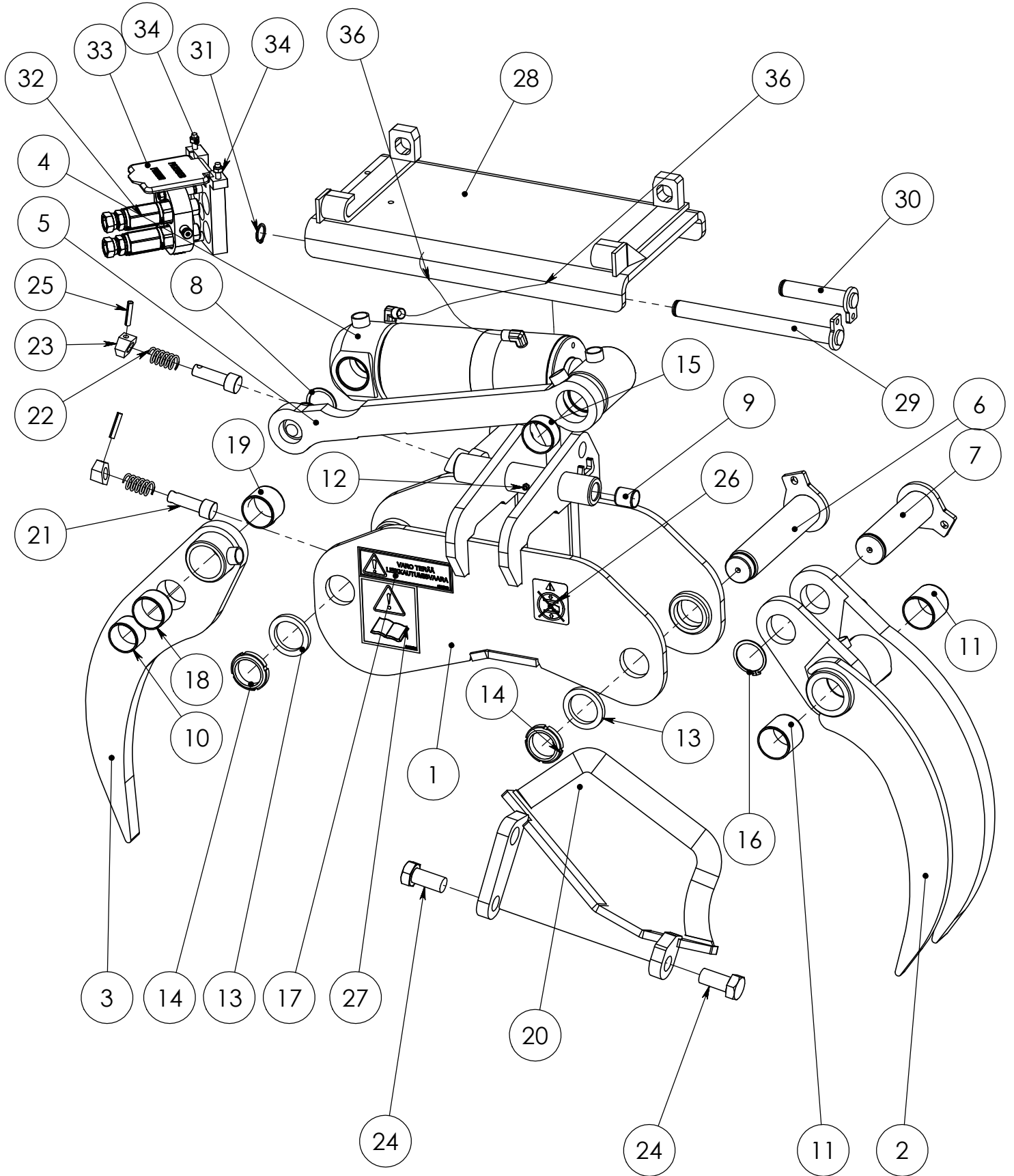



## SPARE PART LIST

|               |             |          |            |
|---------------|-------------|----------|------------|
| Item code     | 29012924    | Revision | -          |
| Title         | KOURA       | Date     | 15.08.2012 |
| Specification | KESLA 19 GA |          |            |

| Pos | Item code | Title  | Specification                            | Dimensions | Pc | Amount | Unit | Nto Weight |
|-----|-----------|--|--|------------|----|--------|------|------------|
| 1   | 29010166  | RUNKO RAM FRAME RAHMEN   | KOURAN RUNKO                             |            | 1  |        |      | 39.06      |
| 2   | 21316171  | LEUKA KLO JAW BACKE  | ALALEUKA                                 |            | 1  |        |      | 22.12      |
| 3   | 21316166  | LEUKA KLO JAW BACKE  | YLÄLEUKA HITS+KON                        |            | 1  |        |      | 10.71      |
| 4   | 28840001  | SYLINTERI CYLINDER CYLINDER ZYLINDER                                 | 110/56X180                               |            | 1  |        |      | 23.83      |
| 5   | 21316164  | TANKO LÄNK LINK STANGE   | VÄLITANKO                                |            | 1  |        |      | 6.23       |
| 6   | 21316160  | AKSELI AXEL AXLE ACHSE   | 50/M45 -247                              |            | 2  |        |      | 3.95       |
| 7   | 21316173  | AKSELI AXEL AXLE ACHSE   | 50-180                                   |            | 1  |        |      | 2.93       |
| 8   | 3060105   | PIDÄTINRENGAS LÅSRING SNAP RING SPRENGRING                           | AS 45X2.5 DIN 471                        |            | 1  |        |      | 0          |
| 9   | 3100116   | LIUKULAAKERI BUSSNING BUSHING GLEITLAGER                             | PM 2530 DX                               |            | 2  |        |      | 0.03       |
| 10  | 3100214   | LIUKULAAKERI BUSSNING BUSHING GLEITLAGER                             | WB 802 4530                              |            | 1  |        |      | 0.09       |
| 11  | 3100257   | LIUKULAAKERI BUSSNING BUSHING GLEITLAGER                             | WB 802 5050                              |            | 2  |        |      | 0.16       |
| 12  | 3050003   | RASVANIPPA SMÖRJNIPPEL GREASE NIPPLE SCHMIERNIPPEL                   | M8X1,25 DIN 71412                        |            | 7  |        |      | 0          |
| 13  | 3030175   | ALUSLEVY BRICKA WASHER UNTERLEGSSCHEIBE                              | 68/50-8 EN 28 DIN 738                    |            | 2  |        |      | 0.1        |
| 14  | 3020163   | MUTTERI MUTTER NUT MUTTER  | KM9 NYLOC M45X1.5 ZN                     |            | 2  |        |      | 0.11       |
| 15  | 3100411   | LIUKULAAKERI BUSSNING BUSHING GLEITLAGER                             | WB 802 5025                              |            | 1  |        |      | 0.08       |
| 16  | 3060003   | PIDÄTINRENGAS LÅSRING SNAP RING SPRENGRING                           | 50 ZN DIN 471                            |            | 1  |        |      | 0          |
| 17  | 3281399   | TARRA DEKAL DECAL AUFKLEBER  | VARO TERÄÄ LEIKKAUTUMISVAARA             |            | 1  |        |      | 0.07       |
| 18  | 3100223   | LIUKULAAKERI BUSSNING BUSHING GLEITLAGER                             | WB 802 5030                              |            | 1  |        |      | 0.1        |
| 19  | 3100224   | LIUKULAAKERI BUSSNING BUSHING GLEITLAGER                             | WB 802 5040                              |            | 1  |        |      | 0.13       |
| 20  | 29010172  | TERÄ KNIV BLADE KLINGE   | HITS                                     |            | 1  |        |      | 8.96       |
| 21  | 90012843  | KARA SPINDEL SPINDLE SPINDEL   | 28/18-76                                 | L=78       | 2  |        |      | 0.2        |
| 22  | 3300533   | JOUSI FJÄDER SPRING FEDER  | 18/45/7.6/6.88 -1643 SF-TF3              |            | 2  |        |      | 0.02       |
| 23  | 29010177  | MUTTERI MUTTER NUT MUTTER  | 32/18-22                                 | L=22       | 2  |        |      | 0.08       |
| 24  | 3010534   | KUUSIORUUVI SEXKANTSKRUV HEW SCREW SECHSKANTSCHRAUBE                 | M24X50 8.8 ZN DIN 933                    |            | 2  |        |      | 0          |
| 25  | 3040015   | SOKKA SAXSPRINT COTTER PIN STIFT                                     | 8X40 ZN DIN 1481                         |            | 2  |        |      | 0          |
| 26  | 3281526   | TARRA (VAROITUS) DEKAL (VARNING) DECAL (WARNING) AUFKLEBER (WARNUNG) |  |            | 1  |        |      | 0          |
| 27  | 3280523   | TARRA DEKAL DECAL AUFKLEBER  | READ INSTRUCTIONS                        |            | 1  |        |      | 0.02       |
| 28  | 29013711  | KIINNIKE FÄSTE FASTENER BEFESTIGUNG                                  |  |            | 1  |        |      | 26.44      |
| 29  | 21316129  | AKSELI AXEL AXLE ACHSE   | 25 -286                                  |            | 1  |        |      | 1.15       |
| 30  | 21316128  | AKSELI AXEL AXLE ACHSE   | 25 -126                                  |            | 1  |        |      | 0.53       |
| 31  | 3060090   | PIDÄTINRENGAS LÅSRING SNAP RING SPRENGRING                           | AS 25X2 ZN DIN 471                       |            | 2  |        |      | 0          |
| 32  | 3302041   | LIITIN KOPPLINGSSTYCKE CONNECTOR KONNEKTOR                           | FASTER PIKALIITIN                        |            | 1  |        |      |            |
| 33  | 3302042   | TELINEN STÄLL RACK GESTELL   | FASTER PIKALIITIMEN TELINE               |            | 1  |        |      | 2.03       |
| 34  | 3020001   | MUTTERI MUTTER NUT MUTTER  | M8 ZN DIN 985                            |            | 2  |        |      | 0.01       |
| 35  | 3010252   | KUUSIOKOLORUUVI INSEKSKRUV ALLEN SCREW INNENSECHSKANTSCHRAUBE        | M8X30 8.8 ZN DIN 912                     |            | 2  |        |      | 0          |
| 36  | 3133269   | HYDRAULILETKU HYDRAULIKSLANG HYDRAULIC HOSE HYDRAULIKSCHLAUCH        | A50001-06-06/222T-06/500120-08-06/L=1500 |            | 2  |        |      | 0          |



## OSALUETTELO

|               |             |         |             |
|---------------|-------------|---------|-------------|
| Nimikenumero  | 29012924    | Revisio | -           |
| Nimitys       | KOURA       | Päiväys | 15.08.2012  |
| Specifikaatio | KESLA 19 GA | Liittyy | AVANT TECNO |

| Pos | Nimike n:o | Nimitys + Specifikaatio       | Mitat | Kpl | Määrä | Yks | Nto paino | Huom |
|-----|------------|-------------------------------|-------|-----|-------|-----|-----------|------|
| 37  | 3281135    | TARRA VAARA-ALUE 25 M, 730X80 |       | 1   |       |     | .1        |      |





## SPARE PART LIST

|               |            |          |            |
|---------------|------------|----------|------------|
| Item code     | 28840001   | Revision | -          |
| Title         | SYLINTERI  | Date     | 10.08.2009 |
| Specification | 110/56X180 |          |            |

| Pos | Item code | Title   | Specification     | Dimensions | Pc | Amount | Unit | Nto Weight |
|-----|-----------|---|-------------------|------------|----|--------|------|------------|
| 1   | 3110757   | MÄNNÄNTIIVISTE KOLV TÄTNING PISTON SEAL KOLBENDICHTUNG              | OK 110/89X8       |            | 1  |        |      | 0.2        |
| 2   | 3110076   | VARRENTIIVISTE KOLVSTÄNGSTÄTNING ROD SEAL DICHTUNG FÜR KOLBENSTANGE | NI 300 56/71X10   |            | 1  |        |      | 0.1        |
| 3   | 3110077   | LUOVUTIN AVSTRYKARE WIPER SEAL ABSTREIFER                           | PW 56             |            | 1  |        |      | 0.04       |
| 4   | 3110259   | O-RENGAS O-RING O-RING O-RING                                       | 104.5X3 90 SHORE  |            | 1  |        |      | 0.02       |
| 5   | 3110669   | O-RENGAS O-RING O-RING O-RING                                       | 45X3 90 SHORE     |            | 1  |        |      | 0.01       |
| 6   | 3110566   | MÄNNÄNOHJAIN KOLV STYRNING PISTON GUIDE KOLBENFÜHRUNG               | E/PWR 110/104X13  |            | 2  |        |      | 0.1        |
| 7   | 28840201  | MÄNTÄ KOLV PISTON KOLBEN  | 110               | L=59       | 1  |        |      | 2.68       |
| 8   | 28840204  | MÄNNÄNVARSI KOLVSTÄNG PISTON ROD KOLBENSTANGE                       | 56 -328 HITS      |            | 1  |        |      | 8.27       |
| 9   | 28840101  | SYLINTERIPUTKI CYLINDERRÖR CYLINDER BARREL ZYLINDERROHR             | 110/56-180        |            | 1  |        |      | 7.97       |
| 10  | 28840202  | OHJAIN STYRNING GUIDANCE STEUERUNG                                  | 110/56            | L=78       | 1  |        |      | 3.76       |
| 11  | 3100224   | LIUKULAAKERI BUSSNING BUSHING GLEITLAGER                            | WB 802 5040       |            | 2  |        |      | 0.13       |
| 12  | 3100257   | LIUKULAAKERI BUSSNING BUSHING GLEITLAGER                            | WB 802 5050       |            | 2  |        |      | 0.16       |
| 13  | 3050003   | RASVANIPPA SMÖRJNIPPEL GREASE NIPPLE SCHMIERNIPPEL                  | M8X1,25 DIN 71412 |            | 2  |        |      | 0          |
| 14  | 3010175   | KUUSIOKOLORUUVI INSEKSKRUV ALLEN SCREW INNENSECHSKANTSCHRAUBE       | M8X10 ZN DIN 914  |            | 1  |        |      | 0          |
| 1-6 | 3110989   | TIIVISTESARJA TÄTNNGSSATS SEAL KIT DICHTUNGSSATZ                    | 110/56            |            | 1  |        |      |            |